

Horseshoe Adapter



This optical accessory is ideal for applications including:

Arrayed Waveguide (AWG)

Planar Circuits

Optical Switches

The EXFO Horseshoe Adapter combines Cure Ring and Light Line technology in a single unit. The Unit couples to standard EXFO Liquid Light guides and transforms a circular spot into two uniform, opposed linear beams. The Horseshoe Adapter is ideal for applications which require simultaneous illumination from two sides



Fiber-optic test,
measurement, monitoring
and automation solutions

EXFO

Specifications

Throughput:	Approximately 50% of the output of an 8mm Liquid Light Guide
Uniformity:	+/- 10% along the beam length
Divergence:	Numerical Aperture 0.22

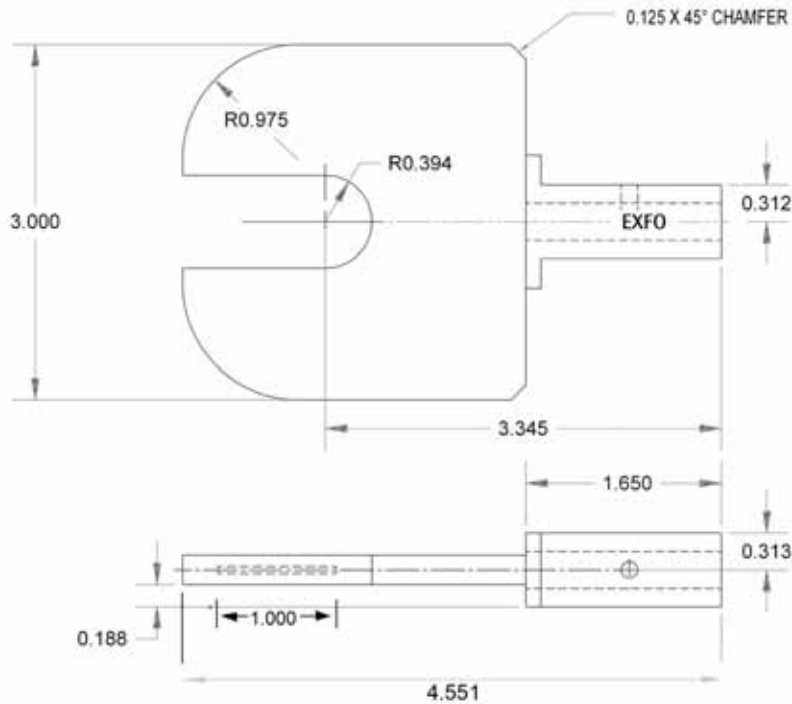

Active Input diameter = 8mm

All dimensions are given in inches.
 Dimensions given for standard horseshoe adapter.
 Customized solutions are available upon request

EXFO PHOTONIC SOLUTIONS	2260 Argentia Road	Mississauga (Ontario) L5N 6H7	Tel.: 1 905 821-2600 . Fax.: 1 905 821-2055
TOLL-FREE	Tel.: 1 800 668-8752		
CORPORATE HEADQUARTERS	465 Godin Avenue	Vanier (Quebec) G1M 3G7 CANADA	Tel.: 1 418 683-0211 . Fax.: 1 418 683-2170
EXFO AMERICA	1201 Richardson Drive, Suite 260	Richardson TX 75080 USA	Tel.: 1 800 663-3963 . Fax.: 1 972 907-2297
EXFO EUROPE	Le Dynastuer, 10/12 rue Andras Beck	92366 Meudon la Forêt Cedex FRANCE	Tel.: +33.1.40.83.85..85 . Fax.: +33.1.40.83.04.42
EXFO ASIA-PACIFIC	151 Chin Swee Road, #03-29 Manhattan House	SINGAPORE 169876	Tel.: +65 333 8241 . Fax.: +65 333 8242
TOLL-FREE (USA and Canada)	Tel.: 1 800 663-3936	www.exfo.com • info@exfo.com	

EXFO is certified ISO 9001 and attests to the quality of these products. This device complies with Part 15 of the FCC rules. Operation is subject to the following two conditions: (1) this device may not cause harmful interference, and (2) this device must accept any interference received, including interference that may cause undesired operation. EXFO has made every effort to ensure that the information contained in this specification sheet is accurate. However we accept no responsibility for any errors or omissions, and we reserve the right to modify design, characteristics and products at any time without obligation. Units of measurement in this document conform to SI standards and practices. **Contact EXFO for prices and availability or to obtain the phone number of your local EXFO distributor.**

For the most recent version of this spec sheet, please go to the EXFO website at <http://www.exfo.com/support/techdocs.asp>
 In case of discrepancy, the Web version takes precedence over any printed literature.

